

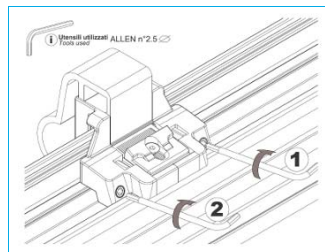

Easy Ring:
new adjustable fast-fit catch with internal fixing

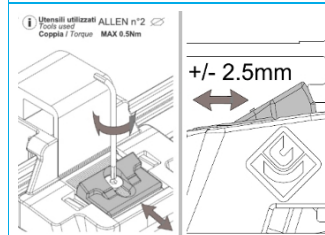

The accessory can be installed in a few simple steps, thanks to the **fixing by grub screws, hidden in the internal part of the profile.**



Its **slide mechanism** allows it to be **adjusted (+/- 2.5mm)** with a hexagonal wrench, and it is suitable for any type of profile.

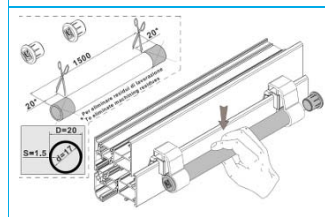

Thanks to the **20 mm diameter shaped maneuvering body**, it is possible to **operate more catches simultaneously** with the help of a **standard connection bar.**

EASY RING	
Art. 1504.1	"EASY RING" Adjustable catch with internal fixing Euro Groove
Art. 1504.2	"EASY RING" Adjustable catch with internal fixing R-systems
Art. 1504.20	"EASY RING" connection bar L 1500 mm

[CLICK HERE TO READ THE NEWS](#)

www.masteritaly.com



Scarica la newsletter per la stampa